

Port of: **Das Zirku & Mubarraz**

Port Marine Notice

No. DZM/MN/004/2019

05/03/2019

To: **All Shipping
Port Operators
Port Users
Shipping Agents**

Subject: Geotechnical Survey from Zirku to Umm Al Anbar (Western Island)

Please be advised that MV Pioneer will commence a Geotechnical survey for new proposed 28" Pipeline from Zirku to Umm Al Anbar (Western Island), The survey will commence on 05th of March 2019.

The route is shown on the appended chart.

There will be a 500 Meters exclusion zone around the survey vessels.

All vessels and crafts are requested to navigate with caution whilst transiting near the vessel work zone.

CAUTION: When in the vicinity of the working area mariners are reminded to:

- Maintain a proper lookout.
- Proceed at a safe speed and navigate with caution.
- Keep well clear from the survey vessel.
- Maintain a listening watch on VHF Channel 12/23 (Das Port Control/VTIS)

Any clarification related to this **Port Marine Notice**, may be directed to the Harbor Master at
Tel: **+971 260 28999/ppadas@adnoc.ae/vtisdas@adnoc.ae**



Harbour Master

Port of: **Das Zirku & Mubarraz**



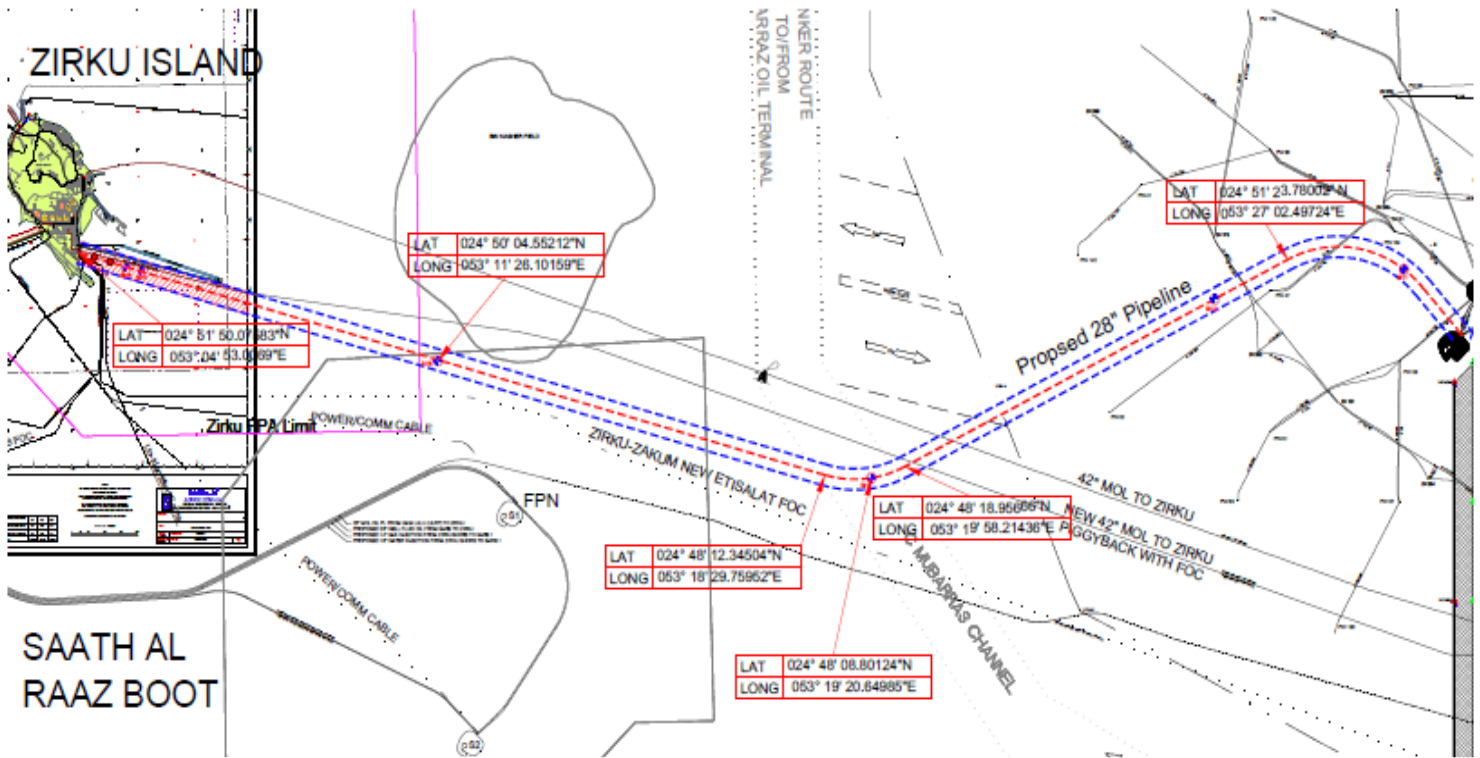

PLOTTED ROUTE CORDINATIES IN WGS 84		
	LATITUDE	LONGITUDE
1	N 024° 51' 23.78002"	E 053° 27' 02.49724"
2	N 024° 48' 18.95666"	E 053° 19' 58.21436"
3	N 024° 48' 08.80124"	E 053° 19' 20.64985"
4	N 024° 48' 12.34504"	E 053° 18' 29.75952"
5	N 024° 50' 04.55212"	E 053° 11' 26.10159"
6	N 024° 51' 50.07583"	E 053° 04' 53.0069"